

BO-62

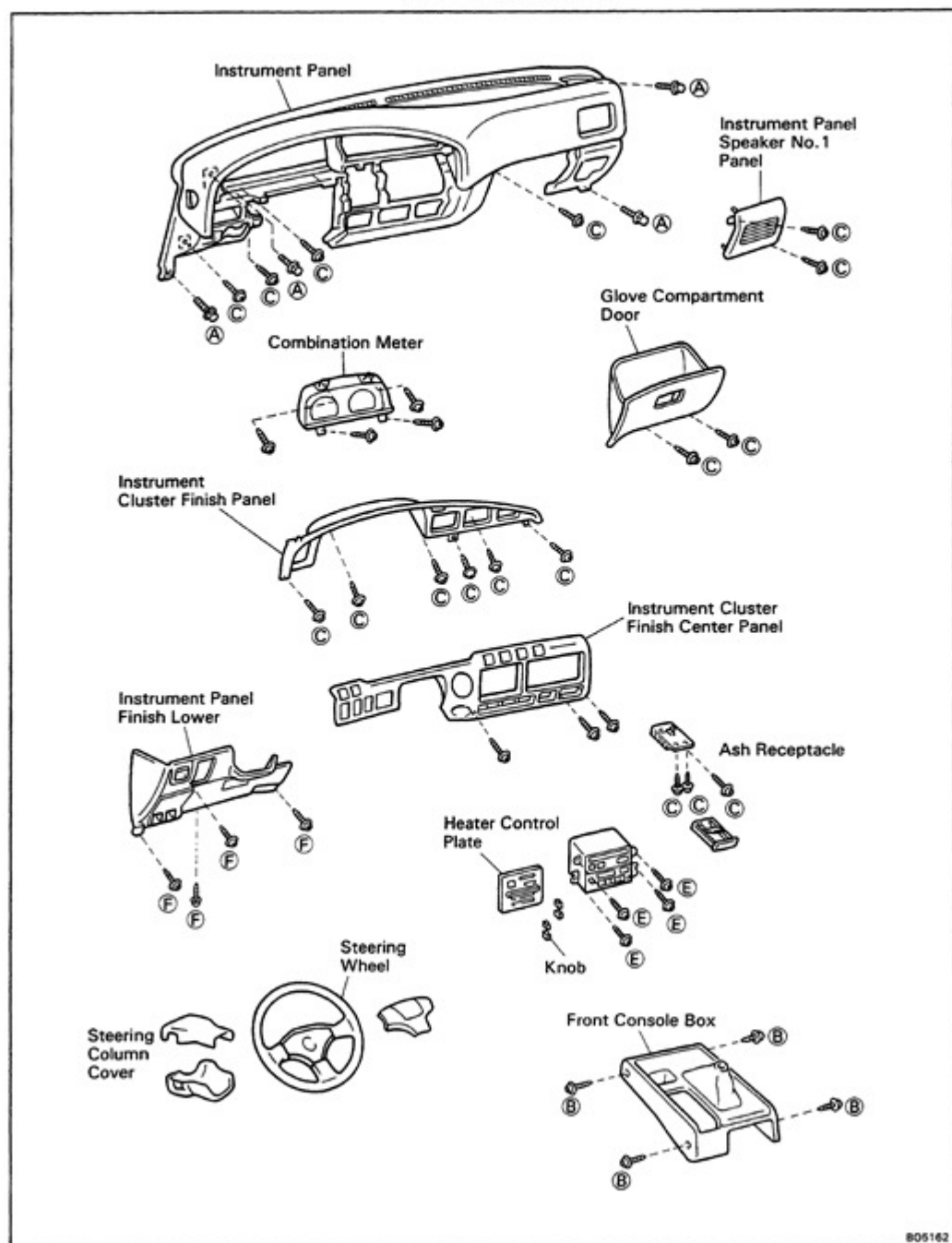



BODY - Instrument Panel

INSTRUMENT PANEL COMPONENTS



HINT: Screw sizes in the previous illustration are indicated according to the code below.

mm (in.)

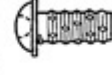
Code	Shape	S	Code	Shape	Size	Code	Shape	Size
(A)		$\phi = 6$ _i (0.24) _z L = 25 _e (0.98)	(B)		$\phi = 5$ (0.20) L = 25 (0.98)	(C)		$\phi = 5.22$ (0.2055) L = 14 (0.55)
(D)		$\phi = 8$ (0.31) L = 30 (1.18)	(E)		$\phi = 5$ (0.20) L = 16 (0.62)	(F)		$\phi = 5.22$ (0.2055) L = 18 (0.71)

REMOVAL OF INSTRUMENT PANEL

(See page [BO-62](#))

1. DISCONNECT BATTERY CABLE FROM NEGATIVE TERMINAL
2. REMOVE STEERING WHEEL
(See page [SR-4](#))

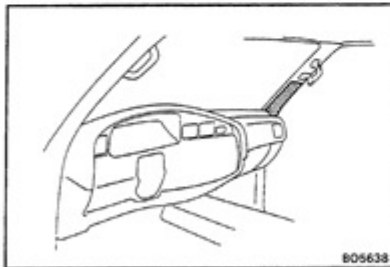

3. APPLY PROTECTION TAPE

Before removing the instrument panel, apply protection tape to the pillars.

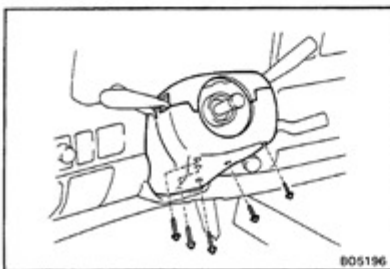

4. REMOVE STEERING COLUMN COVER

Remove five screws and column covers.

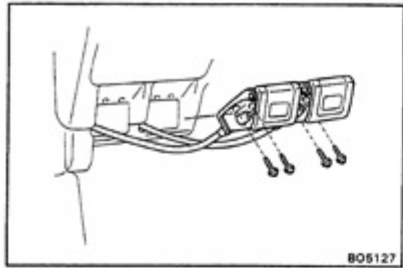
BO-64**BODY** - Instrument Panel**5. REMOVE ENGINE HOOD AND FUEL LID RELEASE LEVER**

Remove four screws and the levers.

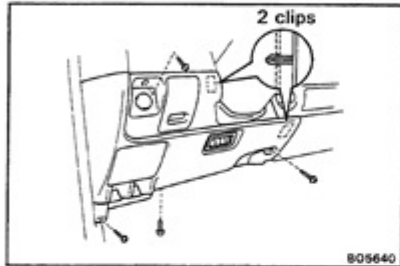
**6. REMOVE LOWER FINISH PANEL**

Remove four screws and the panel.

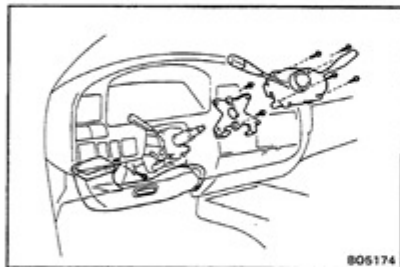
**7. REMOVE DUCT HEATER TO REGISTER N4.2**

Remove the screw and the duct.

8. REMOVE COMBINATION SWITCH

Remove four screws and the combination switch, then disconnect the connectors.

9. REMOVE TURN SIGNAL BRACKET

Remove two bolts and the bracket.

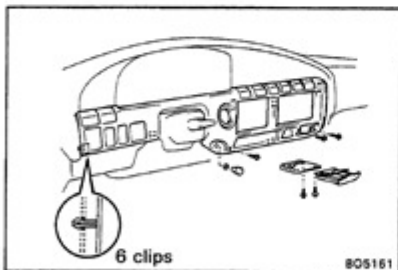
**10. REMOVE INSTRUMENT CLUSTER FINISH CENTER PANEL**

(a) (w/ Manual choke)

Remove the choke knob by pulling.

(b) Remove the ashtray.

(c) Remove three screws and the ash receptacle.

(d) Remove the instrument cluster finish center panel then disconnect the connectors.

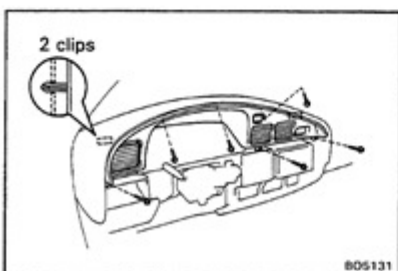
**11. REMOVE INSTRUMENT CLUSTER FINISH PANEL**

Remove six screws and the instrument cluster finish panel.

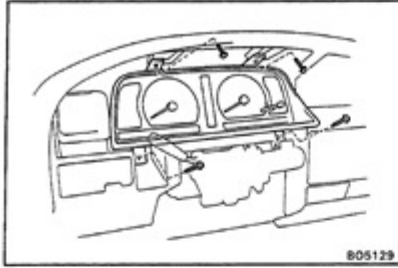
**12. REMOVE COMBINATION METER**

- (a) Remove four screws.
- (b) Disconnect the connectors and the speed meter cable, and remove the meter.

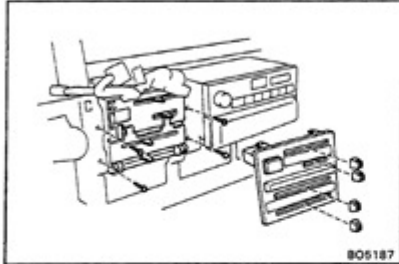
**13. REMOVE HEATER CONTROL UNIT**

- (a) Remove four knobs and the name plate.
- (b) Remove four screws and hang the heater control unit.

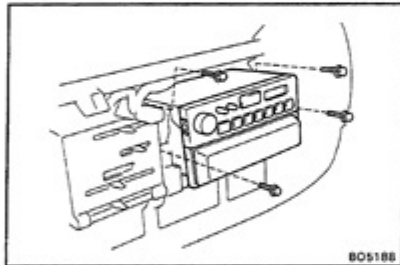
**14. REMOVE RADIO**

- Remove four bolts and the radio then disconnect the connectors.

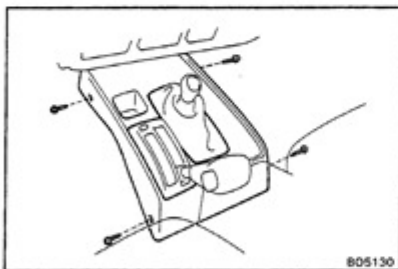
**15. REMOVE FRONT CONSOL BOX**

- Remove four screws and the consol box.

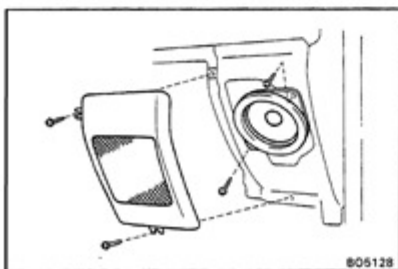
**16. REMOVE INSTRUMENT PANEL SPEAKER**

- (a) Remove two screws and the speaker No. 1 panel.
- (b) Remove two screws and speaker, then disconnect the connector.

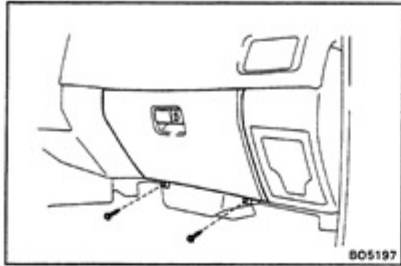
BO-66**BODY** - Instrument Panel**17. REMOVE GLOVE COMPARTMENT DOOR**

Remove two screws and the compartment door.

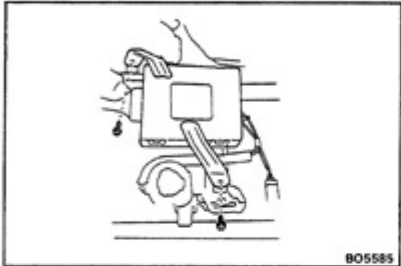
**18. REMOVE ENGINE ECU**

Remove two screws and the ECU, then disconnect the connector.

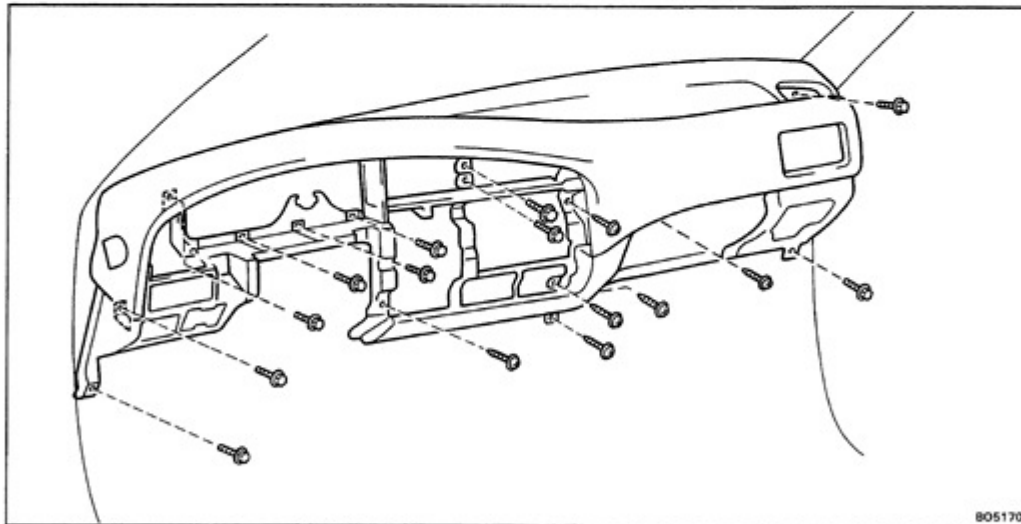
19. REMOVE INSTRUMENT PANEL

Remove ten bolts, six screws and the instrument panel.

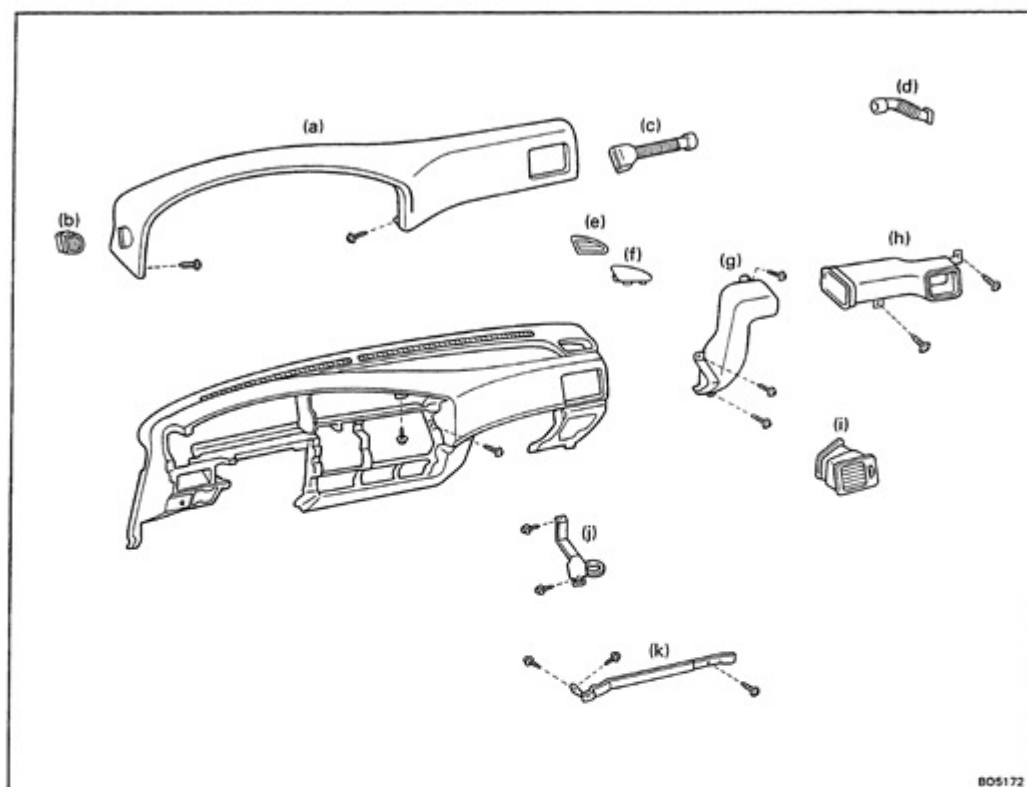
20. REMOVE FOLLOWING PARTS FROM INSTRUMENT PANEL

- (a) Safety Pad
- (b) Side Defroster No. 1 Nozzle
- (c) Side Defroster Nozzle No. 1 Duct
- (d) Side Defroster Nozzle No.2 Duct
- (e) Side Defroster No.2 Nozzle
- (f) Defroster Nozzle Plate
- (g) No.4 Heater Register Duct
- (h) No.5 Heater Register Duct
- (i) Instrument Panel No.2 Register
- (j) Glove Compartment Door Lock Striker Plate
- (k) Glove Compartment Door Reinforcement

INSTALLATION OF INSTRUMENT PANEL

(See page [BO-62](#))

**INSTALL INSTRUMENT PANEL PARTS
FOLLOWING REMOVAL SEQUENCE IN REVERSE**

SEAT BELTS COMPONENTS

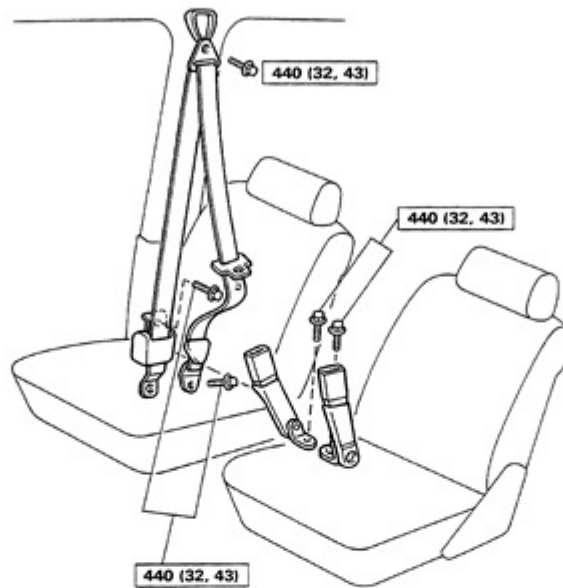
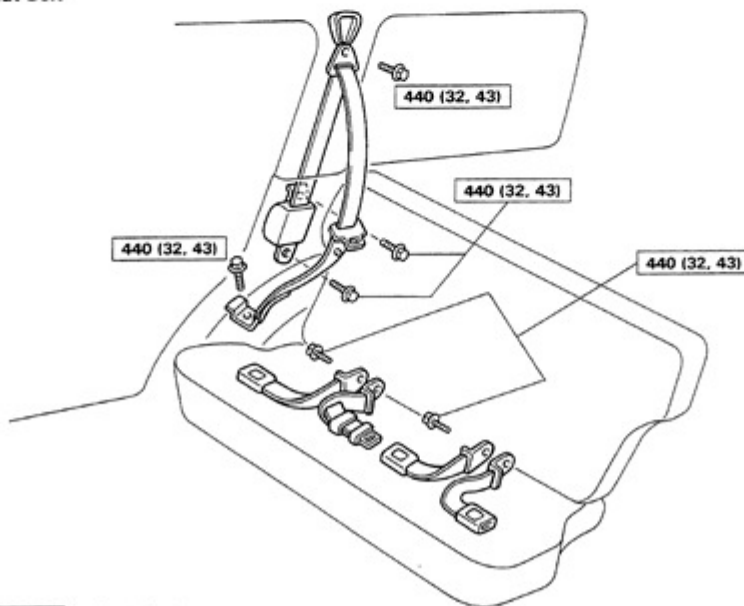
Front Seat Belt**Second Seat Belt**

kg-cm (ft-lb, N·m) : Specified torque

805645
805643

BO-72

BODY - Seat Belts

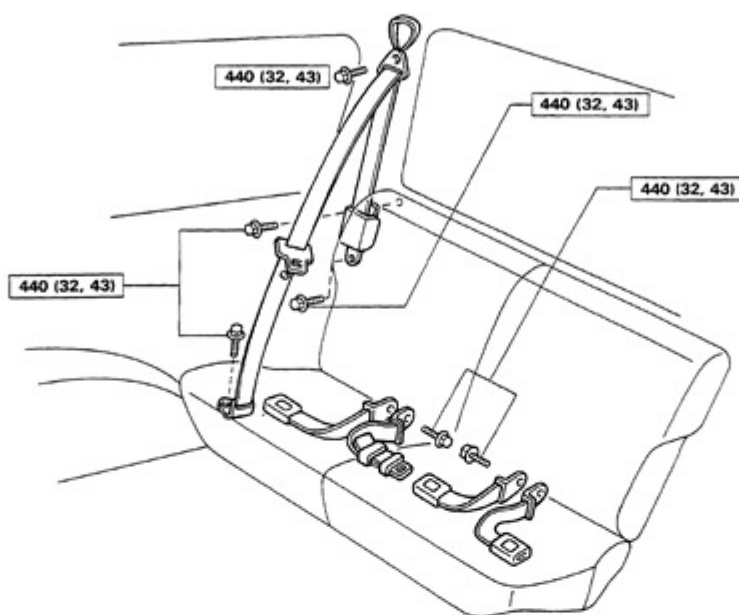
COMPONENTS (Cont'd)**Third Seat Belt****kg-cm (ft-lb, N·m) : Specified torque**

805646



SEAT BELT

[Emergency Locking Retractor (ELR) Type]

1. RUNNING TEST (IN SAFETY AREA)

- (a) Fasten the seat belt.
- (b) Drive the car at 10 mph (16 km/h) and make a very hard stop.
- (c) Check that the seat belt is locked and cannot be extended at this time.

HINT: Conduct this test in safe area. If the belt does not lock, remove the belt mechanism assembly and conduct the following static check. Also, whenever installing a new belt assembly, verify the proper operation before installation.

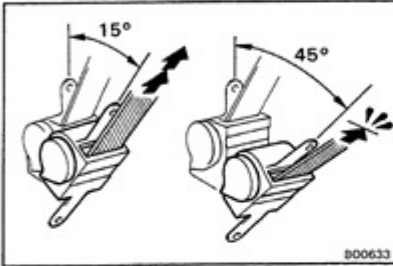

2. STATIC TEST

- (a) Remove the locking retractor assembly.
- (b) Tilt the retractor slowly.
- (c) Verify that the belt can be pulled out at a tilt of 15 degrees or less, and cannot be pulled out at over 45 degrees of tilt.

If a problem is found, replace the assembly.

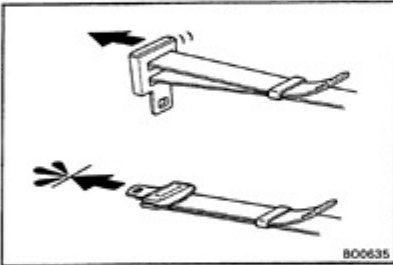

(Manual Type) TESTING

- (a) Adjust the belt to the proper length.
- (b) Apply a firm load to the belt.
- (e) Verify that the belt does not extend.

BO-68

BODY - Seat

SEAT

Front Seat

COMPONENTS

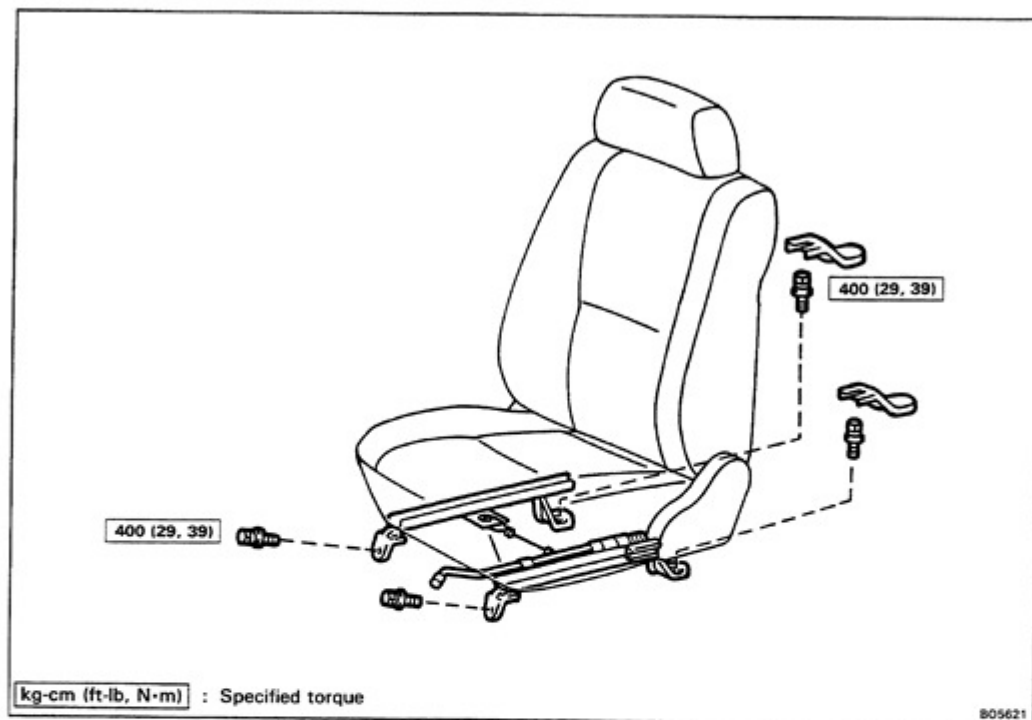

Second Seat COMPONENTS

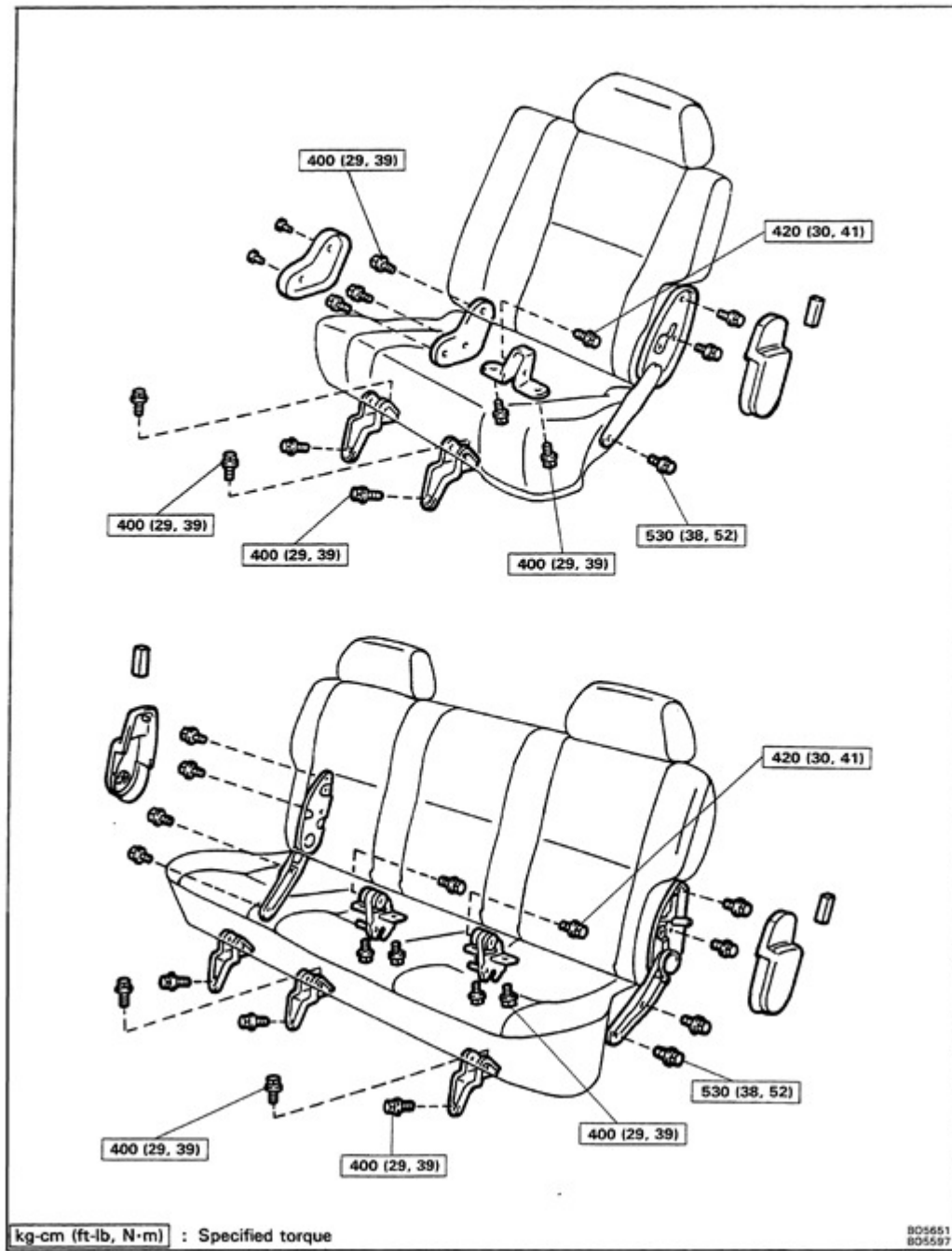

BO-70

BODY - Seat

Third Seat COMPONENTS

